

Student Name: _____

Date: _____ Test Administrator _____

Workplace Math Skills Assessment

Section IV - Scale Drawing

_____ Mastery (7 out of 8 correct)

_____ Referred to training

Use the drawing below to answer questions one through four.

1. What is the length of line A?

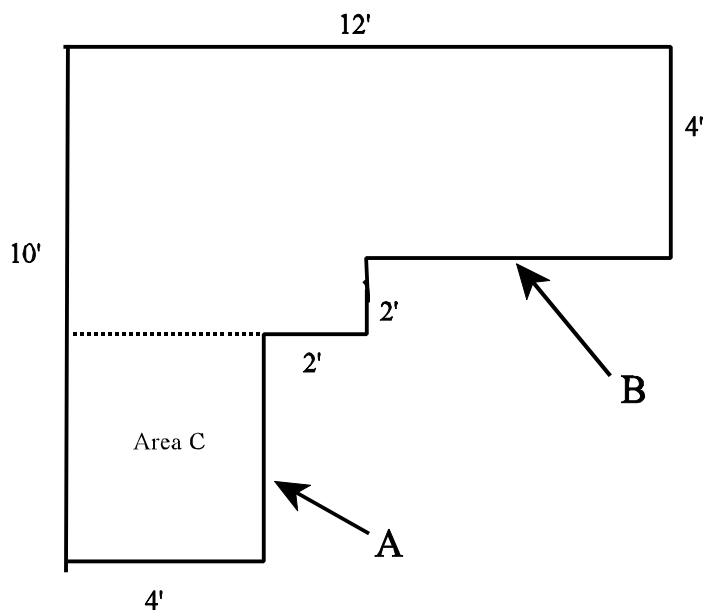

2. What is the length of line B?
3. How many square feet of flooring would it take to cover area C?

4. How many one-foot square tiles would be needed to tile the entire floor?

Use the drawing below to answer questions five through eight.

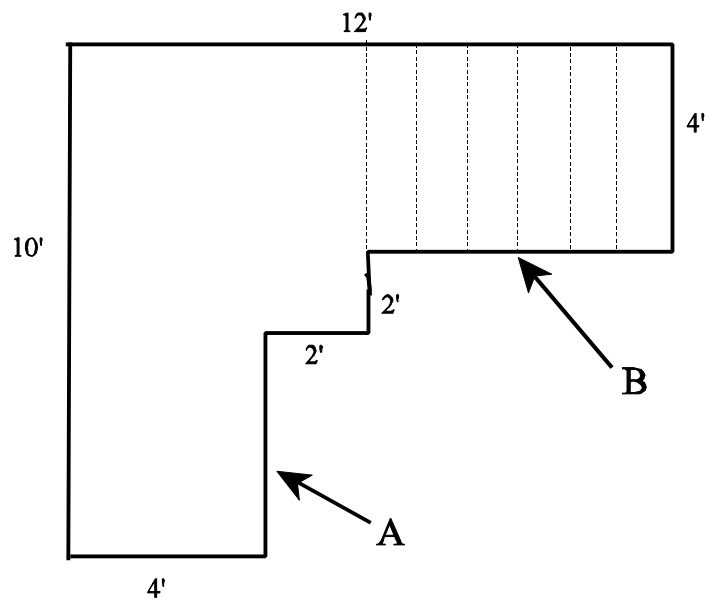

5. If tiles come in boxes of two dozen, how many boxes would have to be purchased to tile the entire floor?
6. If only the lined area is tiled, how many one-foot square tiles will you need?
7. If the unlined area is carpeted, how many square feet of carpet will be needed?
8. How many feet of crown molding would it take to go around the entire ceiling of this room?